

**The 148th Meeting
of the Japanese Society of Conservative Dentistry, 2018**

**The 148th Meeting
of the Japanese Society of Conservative Dentistry, 2018**

Program Schedule

Wed, 13, June

15:00–17:30	JSCD Director and Trustee Meeting	The Yokohama Landmark Tower
19:00–21:00	Reception	The Yokohama Bay Hotel Tokyo

Thu, 14, June

(Yokohama Minato Mirai Hall)

8:30–	Registration	Reception Desk
8:50–9:00	Opening Ceremony	Room A
9:00–10:10	Oral Presentation	Room A,B
10:30–11:50	Plenary Lecture	Room A
12:00–12:50	Luncheon Seminar 1	Room C
13:00–15:30	Symposium I	Room A
15:40–16:20	Poster Presentation	Poster Place
16:30–17:30	Special Concert	Room A
17:40–18:30	Lecture for Board Certified Member	Room A

Fri, 15, June

8:30–	Registration	Reception Desk
8:40– 8:55	Music Performance	Room A
9:00–10:00	Oral Presentation	Room A,B
10:10–12:00	Symposium Organized by the JSCD	Room A
12:10–13:00	Luncheon Seminar 2,3	Room C,D
14:10–14:50	Poster Presentation	Poster Place
15:00–16:00	Symposium II, III	Room A,B
16:00–16:50	Oral Presentation	Room A,B
16:50	Closing	

Guideline for Presentation

The 148th Meeting of the Japanese Society of Conservative Dentistry

(YOKOHAMA MINATO MIRAI HALL, Yokohama, Japan)

June 14 (Thu)-15 (Fri), 2018

Poster Presentation

- Each poster needs to be fixed on the board between 8 : 30 am and 9 : 00 am, June 14.
- Poster should be presented on a poster board in the Poster Place.
- Presenter should be present in front of their posters for discussion from 3 : 40 pm to 4 : 20 pm.
- Dimension of the poster is within 90 (width) × 210 (height) cm (See right).
- Letter-size of the title is more than 4 (width) × 4 (height) cm.
- Presenter's photo required to be attached in the poster, 8 (width) × 10.5 (height) cm.
- Posters will be available for viewing from 9 : 00 am to 3 : 40 pm on June 14, and taken off from 4 : 20 pm to 5 : 30 pm on June 14.

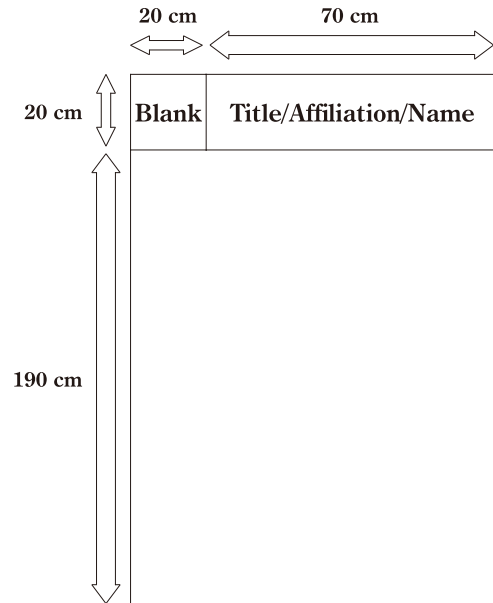

■ Surrounding Area Map ■

YOKOHAMA MINATO MIRAI HALL

〒 220-0012

Minatomirai 2-3-6 Nishi-ku, Yokohama-shi

Tel : 045-682-2020 Fax : 045-682-2023

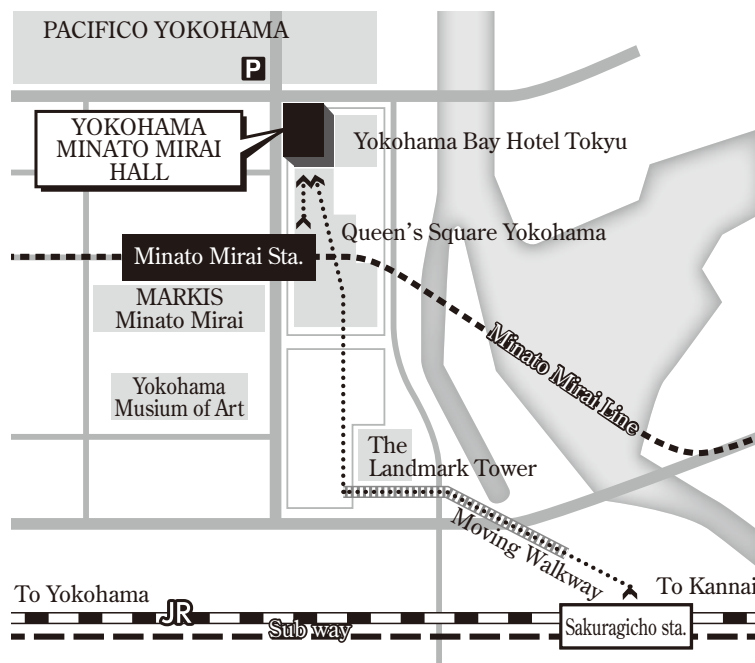

From the Nearest Train Stations

Get off at Minatomirai Station (Tokyu Toyoko Line Direct Line / Minato Mirai Line) and walk 3 minutes from “Queen’s Square Yokohama Exit”

Get off at Sakuragicho Station (JR Keihin Tohoku Line / Negishi Line / Yokohama Municipal Subway), From Queen’s Square 1 st floor (12 min. On foot) via Landmark Plaza from the moving walkway.

Floor Guide

2F

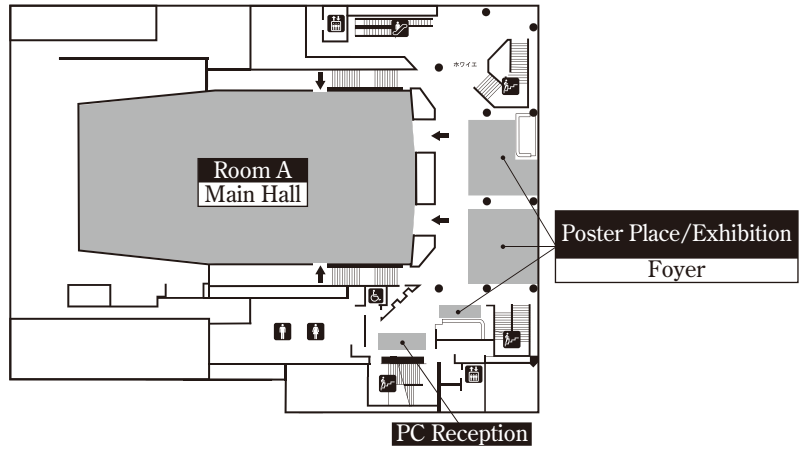

1F

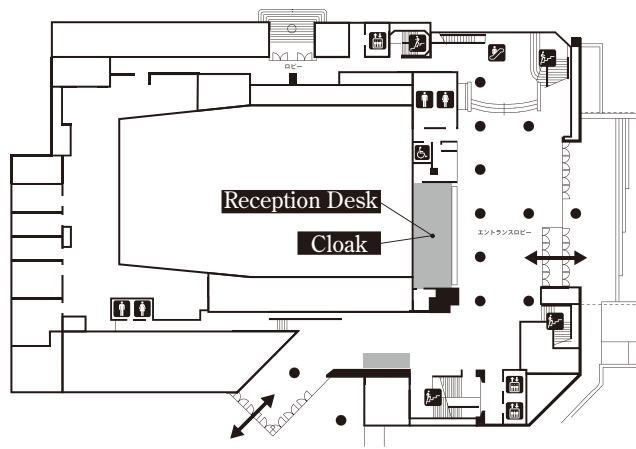

B1F

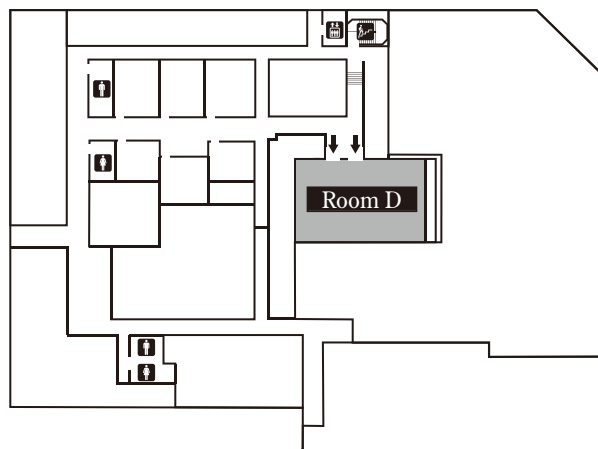

6F

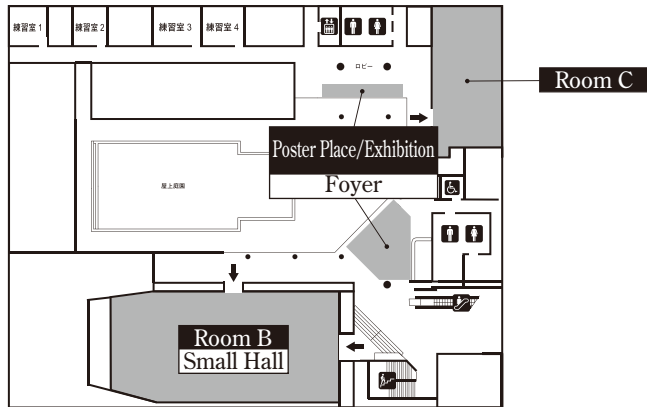

4F

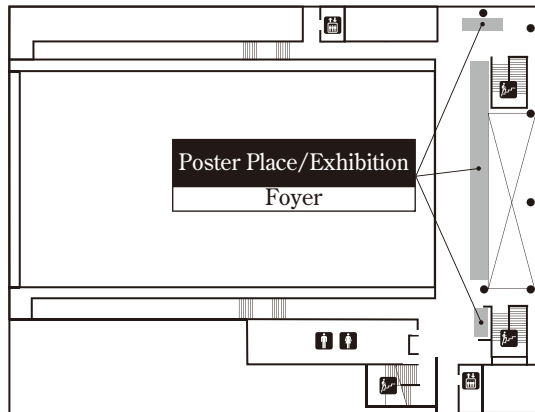

3F

