

**The 150th Meeting  
of the Japanese Society of Conservative Dentistry, 2019**

**The 150th Meeting  
of the Japanese Society of Conservative Dentistry, 2019**

**Program Schedule**

**Wed, 26, June**

---

15:00–18:00 JSCD Director and Trustee Meeting

**ANA Crowne Plaza Kanazawa**

**Thu, 27, June**

---

**Ishikawa Ongakudo**

8:30– Registration Reception Desk

9:00–9:10 Opening Ceremony Room A

9:10–10:00 Oral Presentation Room A,B

10:20–11:50 Symposium Room A

12:10–13:00 Luncheon Seminar 1 Room A

13:10–14:00 Poster Presentation Poster Place

14:10–16:10 Symposium Room A

16:30–17:30 Lecture for Board Certified Member Room A

18:30–20:00 Reception

**ANA Crowne Plaza Kanazawa**

**Fri, 28, June**

---

**Ishikawa Ongakudo**

8:30– Registration Reception Desk

9:00–10:00 Oral Presentation Room A,B

10:10–12:00 Symposium Room A

12:20–13:10 Luncheon Seminar 2,3 Room A,B

14:50–15:40 Poster Presentation Poster Place

15:50–16:50 Oral Presentation Room A,B

16:50 Closing

# Guideline for Presentation

## The 150th Meeting of the Japanese Society of Conservative Dentistry

(ISHIKAWA ONGAKUDO, Kanazawa, Japan)

June 27 (Thu)-28 (Fri), 2019

### Poster Presentation

- Each poster needs to be fixed on the board between 8 : 30 am and 9 : 30 am, June 27.
- Poster should be presented on a poster board in the Poster Place.
- Presenters should be present in front of their posters for discussion from 1 : 10 pm to 2 : 00 pm.
- Dimension of the poster is within 90 (width) × 210 (height) cm (See right).
- Letter-size of the title is more than 4 (width) × 4 (height) cm.
- Presenter's photo required to be attached in the poster, with 8 (width) × 10.5 (height) cm.
- Posters will be available for viewing from 9 : 30 am to 2 : 00 pm on June 27, and taken off from 2 : 00 pm to 2 : 20 pm on June 27.

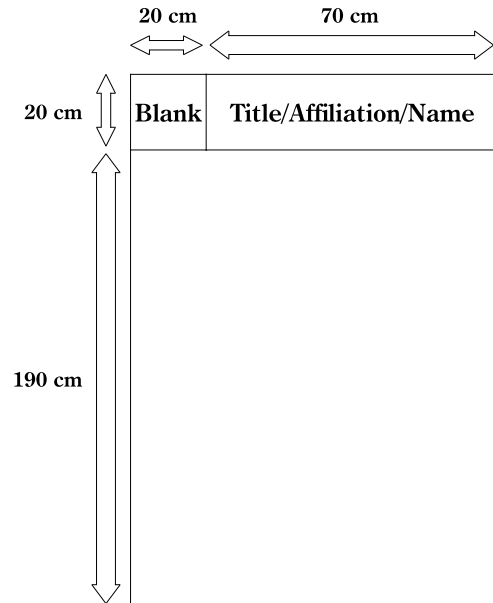

# Surrounding Area Map

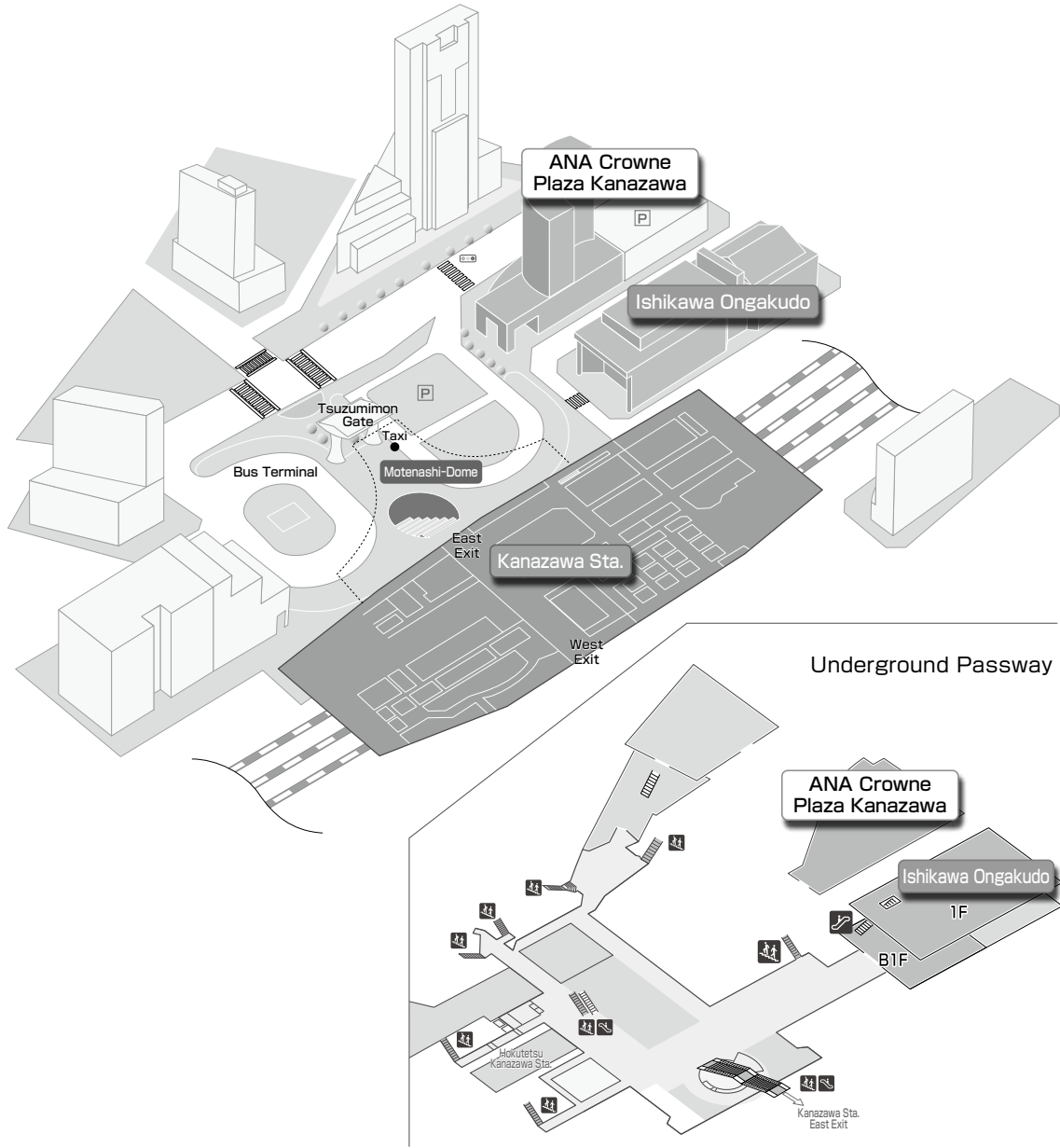

# Floor Guide

**2F**

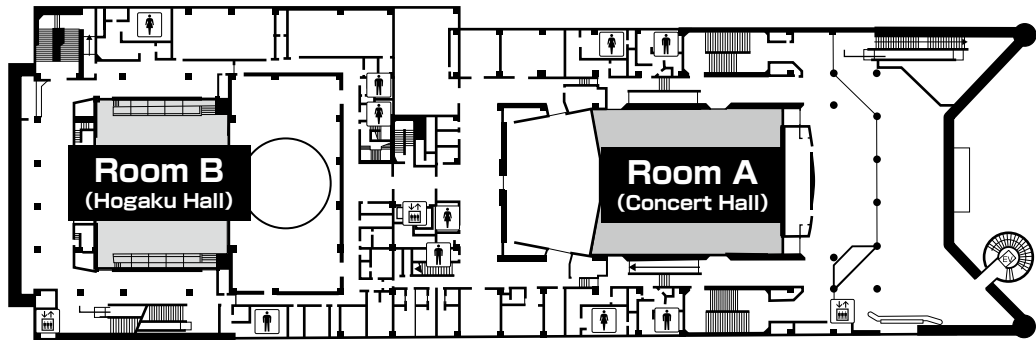

**1F**

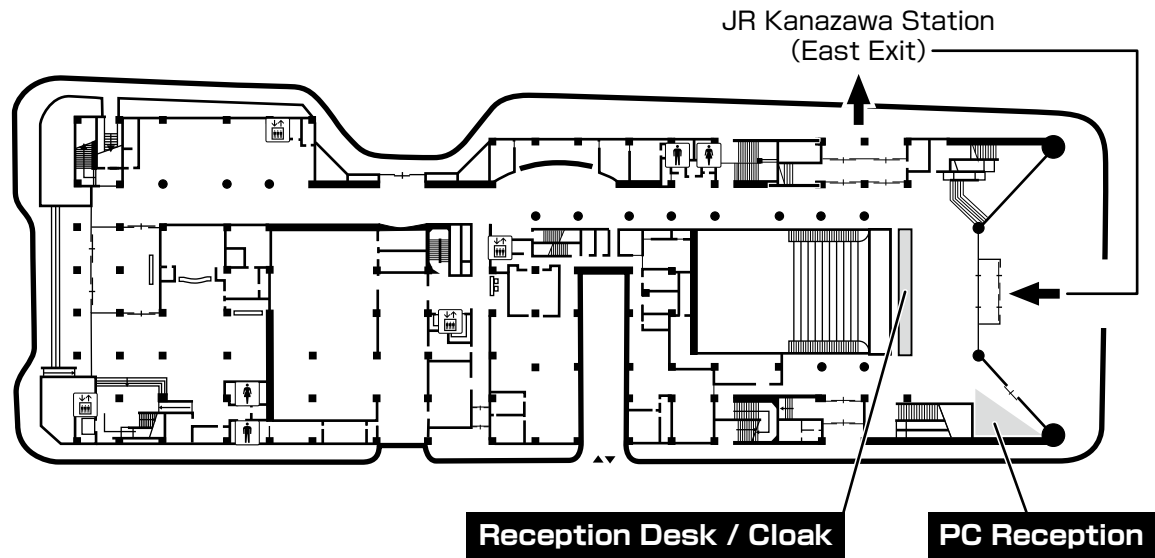

**B1F**

